



MAIN FLOOR

Spring | Summer | Fall | Winter

Wedding Layout

OPTION 1

Guest Seating: 94 + bride and groom = **96 total**

Upstairs: DJ table

All guest seating inside on main floor with cocktail hour and food on the front patio and courtyard.

Winter Ceremony Option: Bride walks down stairs to the double doors where the sweetheart table is. The sweetheart table is set up after the ceremony.

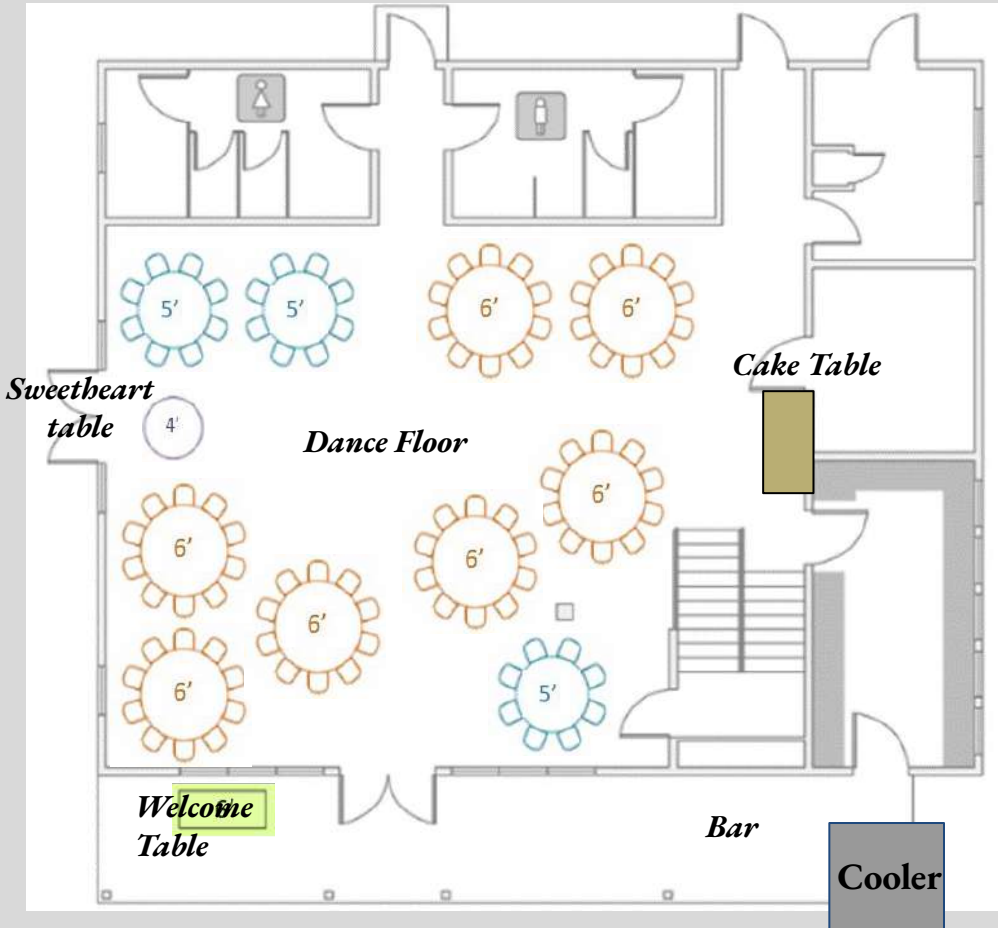



PATIO & COURTYARD

OPTION 1

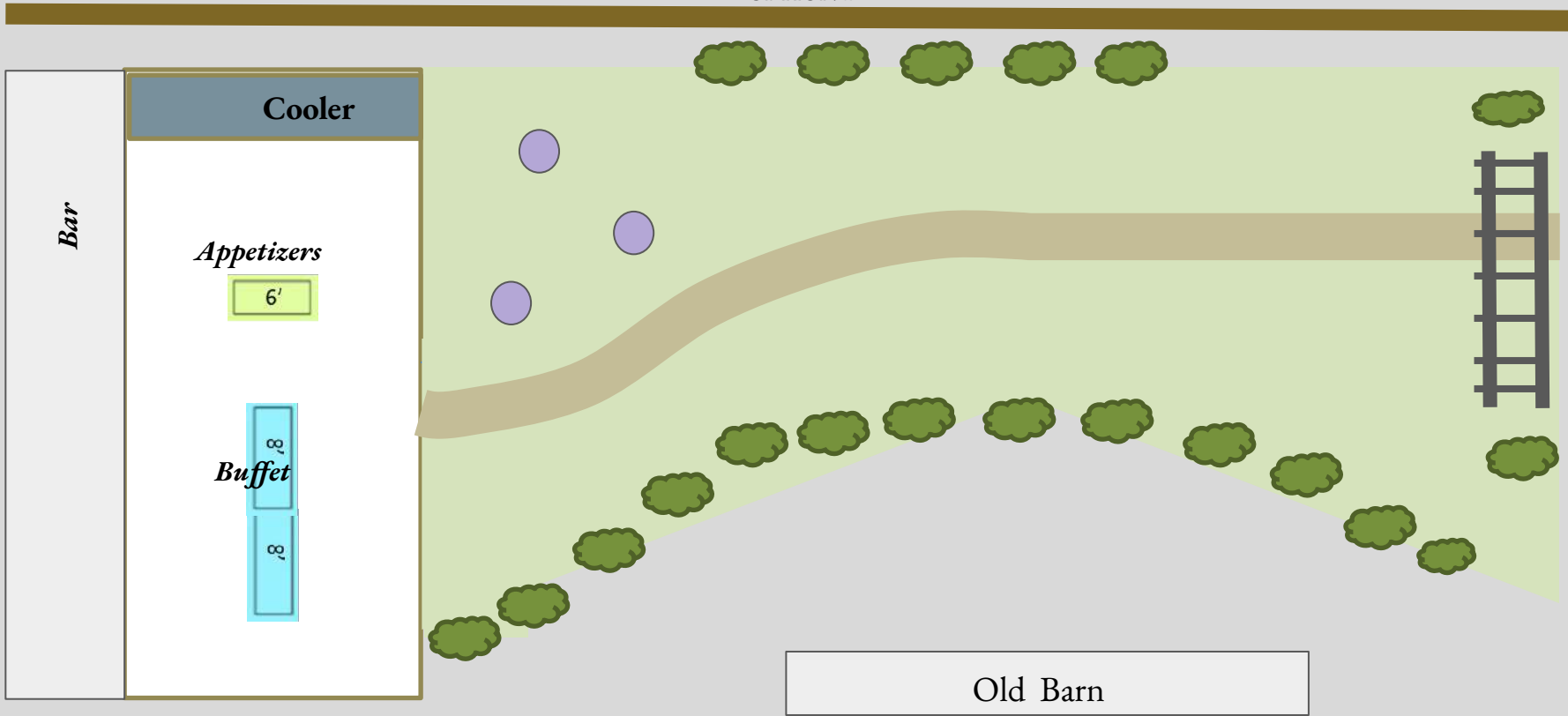



MAIN FLOOR

Spring | Summer | Fall | Winter

Wedding Layout

OPTION 2

Main Floor: 96 guests - bride & groom seated with guests

Upstairs: 50 guests

146 guests total

All guest seating inside on main floor with cocktail hour and food on the front patio and courtyard.

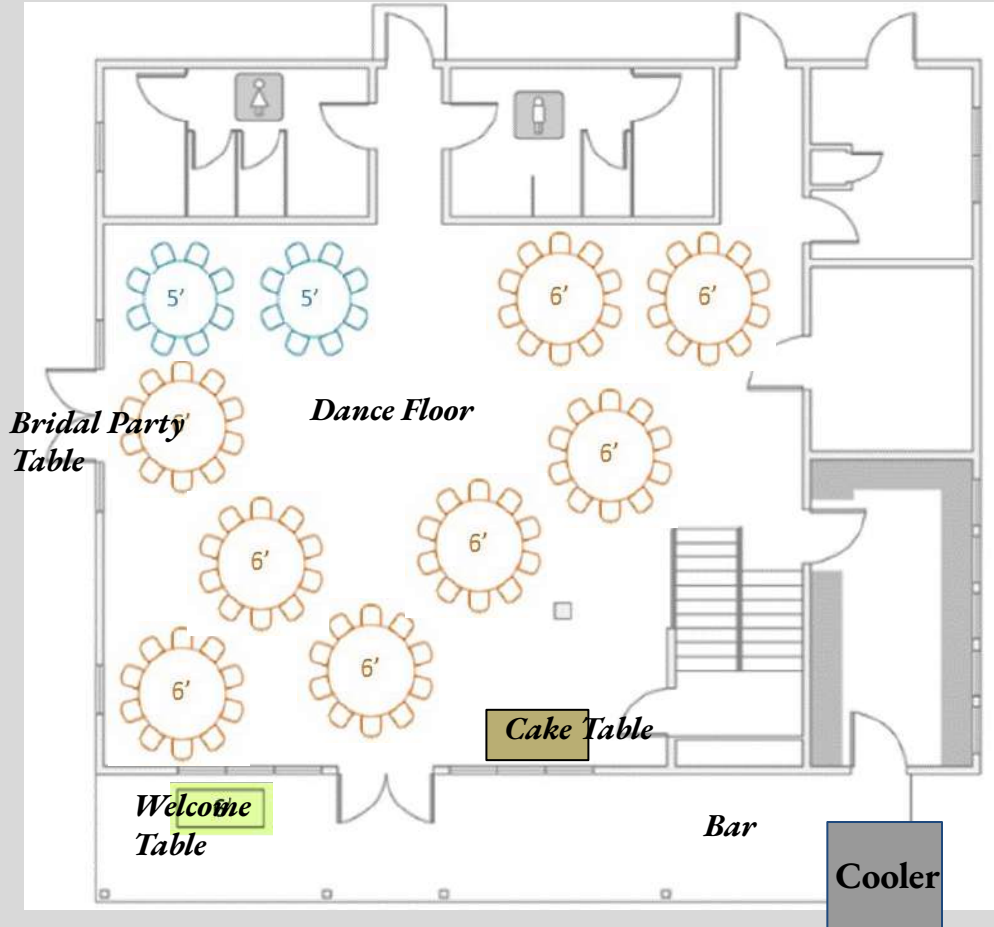



SECOND FLOOR

Spring | Summer | Fall | Winter Wedding Layout

OPTION 2

Winter Ceremony Options: Bride comes down the stairs from the bridal suite to the dance floor space. The guests from upstairs stand around the balcony to watch the ceremony.

Another Ceremony Option: Bride comes down the stairs from the bridal suite to the double doors where the 6' round table where the bridal party will be seated after the ceremony. The table is then set up during cocktail hour.

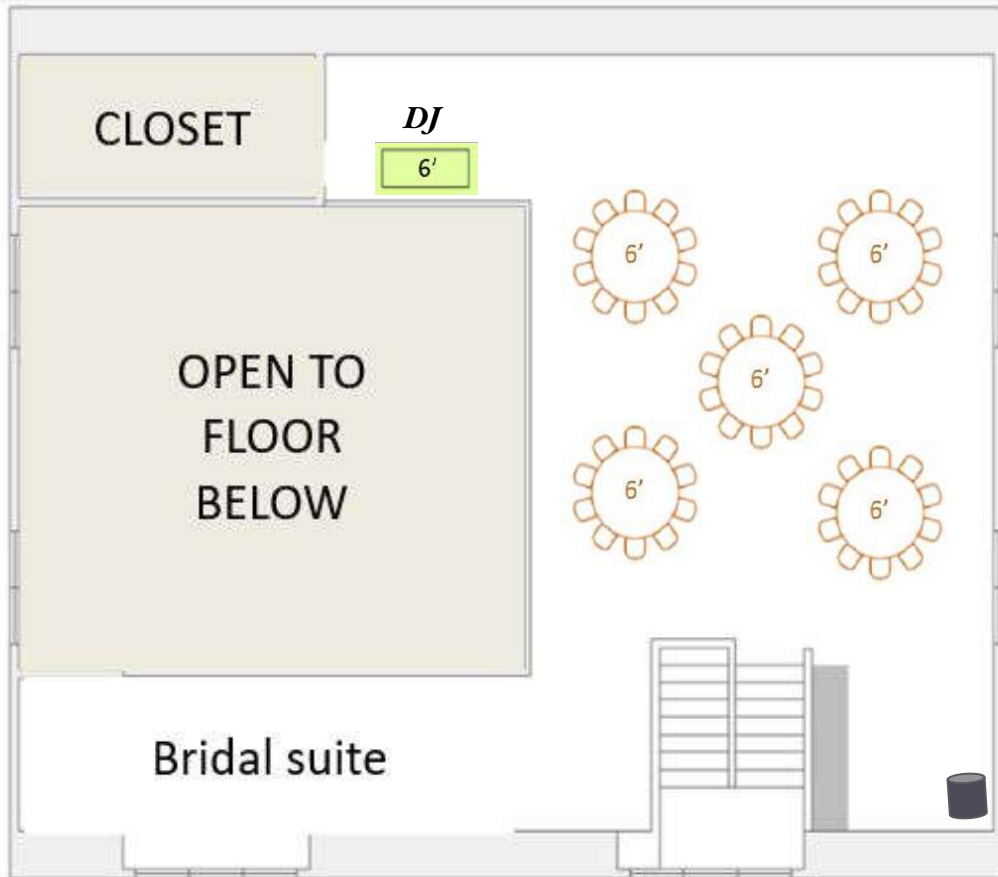



PATIO & COURTYARD

OPTION 2

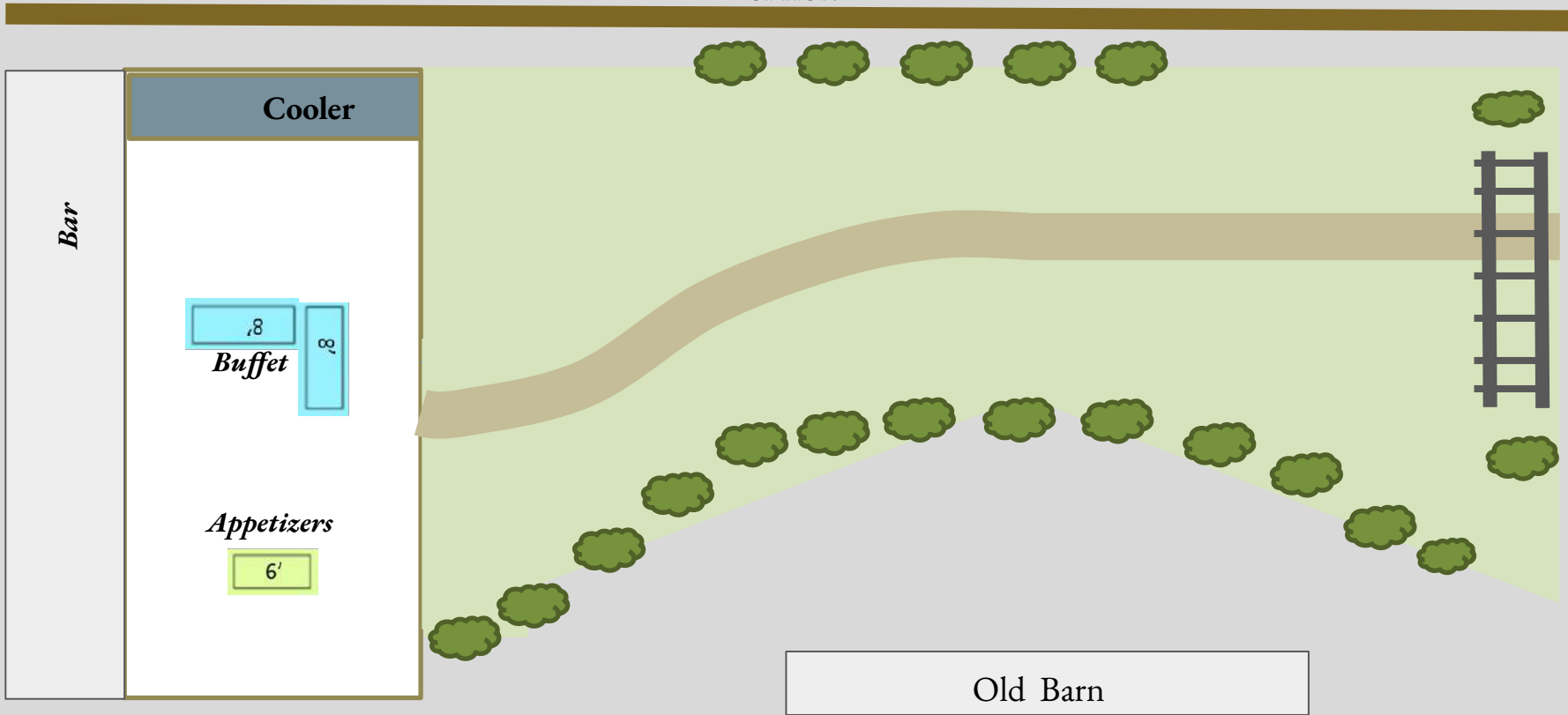

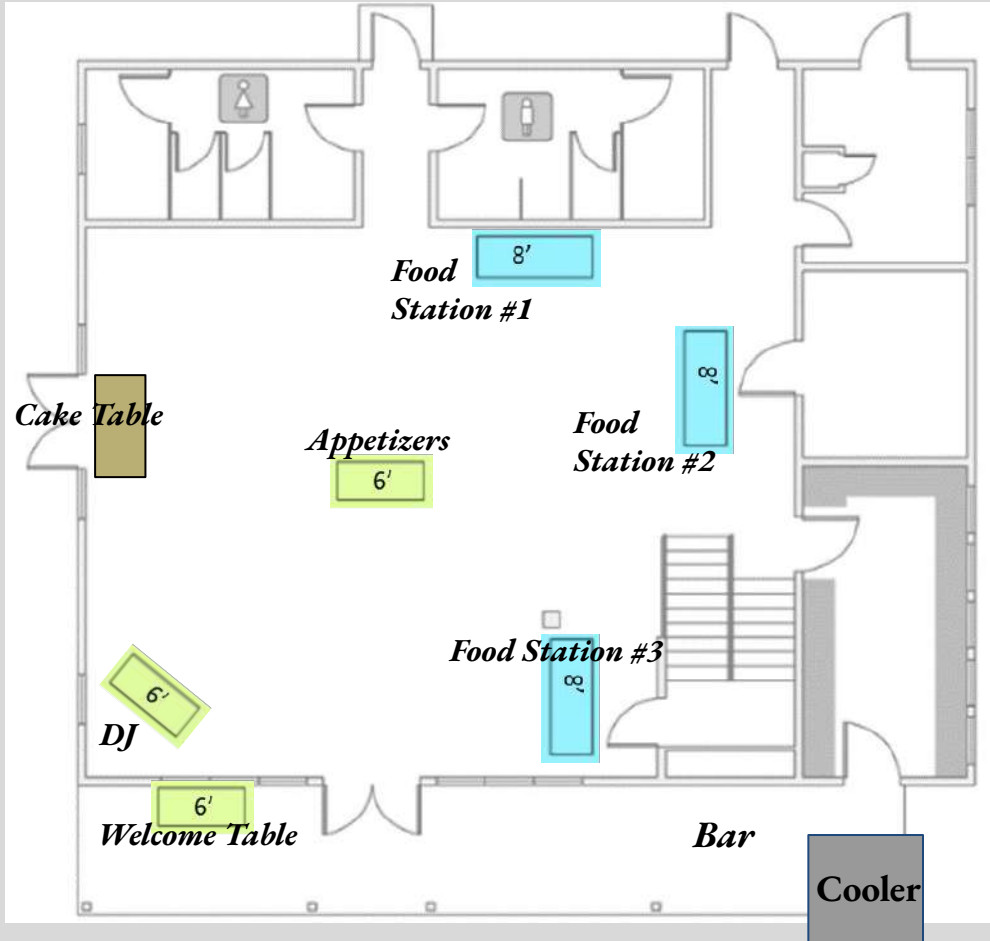

MAIN FLOOR

Spring | Summer | Fall

Wedding Layout

OPTION 3

Inside: Appetizer table would be taken down after cocktail hour to make room for dancing after dinner

Courtyard: Guest seating for 100 guests + 16 at Community Table = **116 total**



PATIO & COURTYARD

OPTION 3

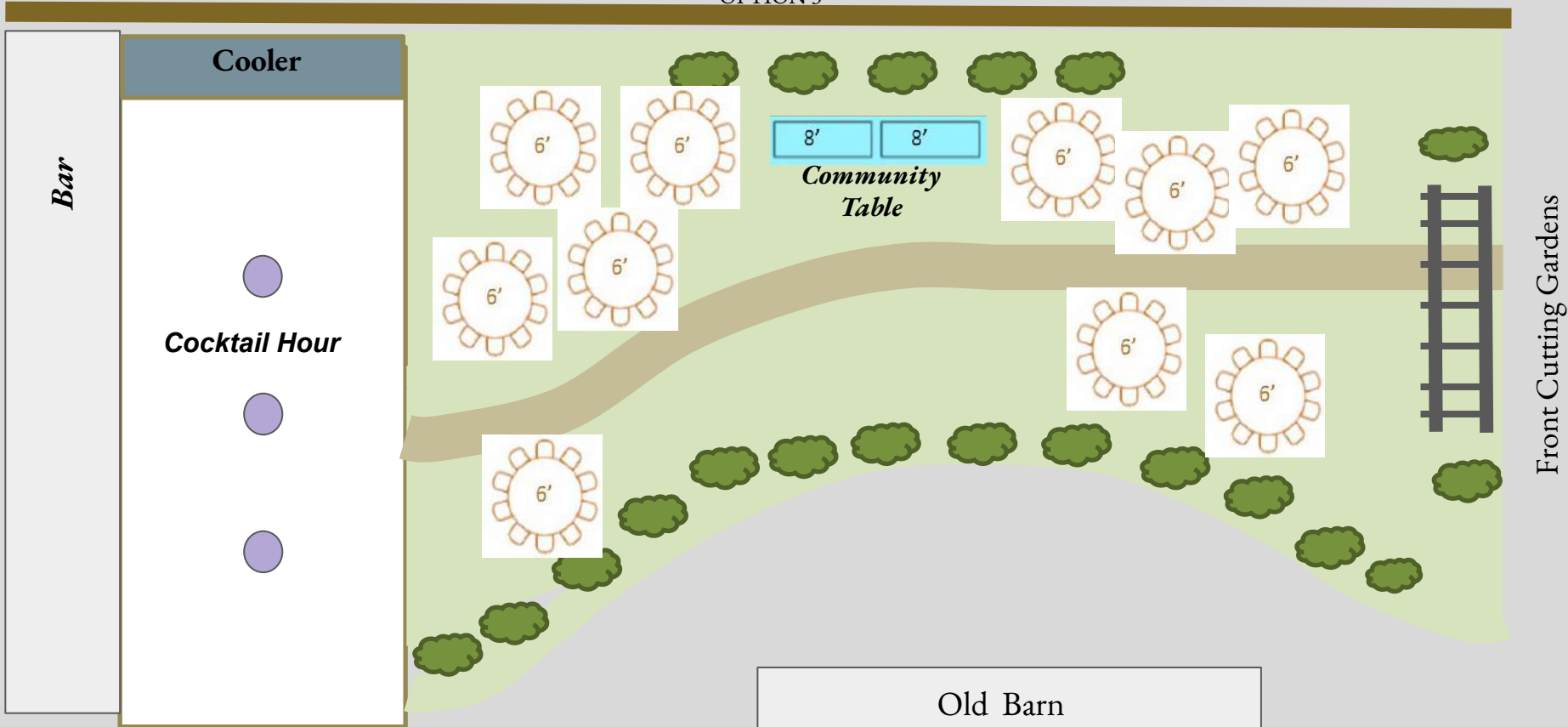

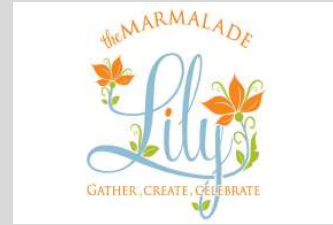

MAIN FLOOR

Spring | Summer | Fall | Winter
Wedding Layout

OPTION 4

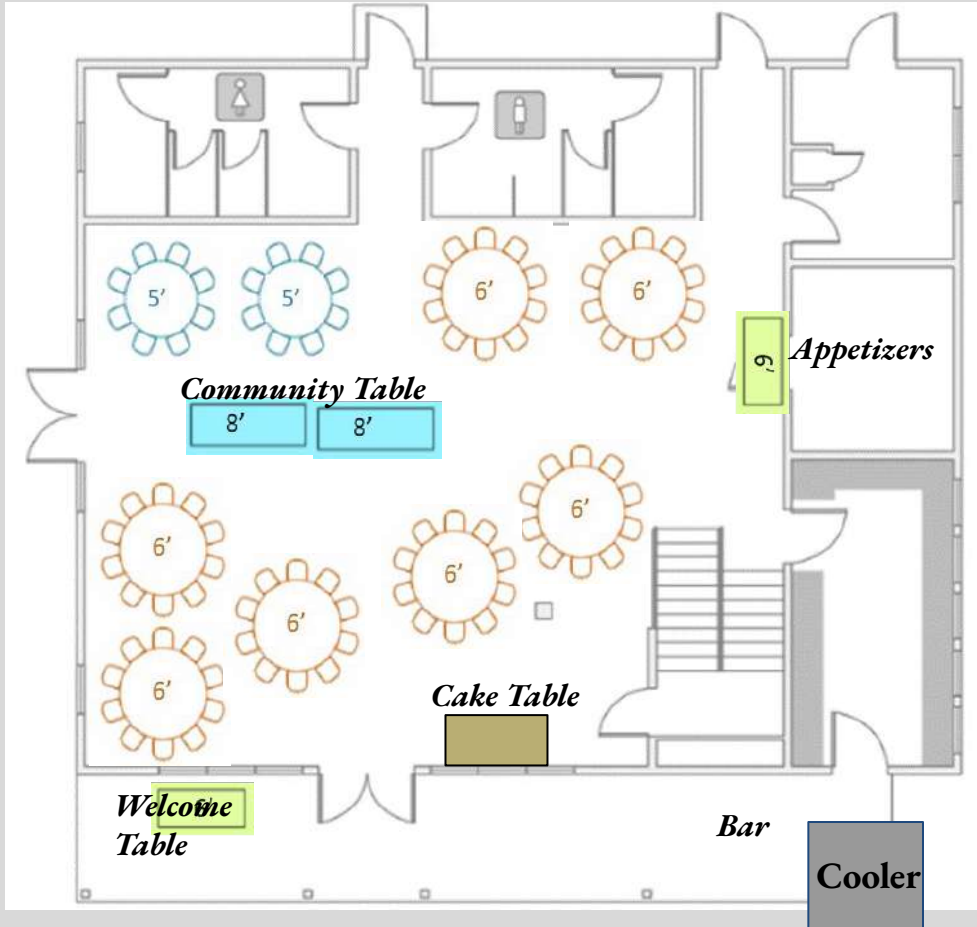

Guest Seating: 50 guests upstairs + 86 guests downstairs + 16 at community table = **152 total**

Community Table taken down after dinner for dancing.



SECOND FLOOR

Spring | Summer | Fall |
Winter Wedding Layout

OPTION 4

Winter Ceremony Option: Bride comes down the stairs from the bridal suite to the double doors where the 6' round table where the bridal party will be seated after the ceremony. The table is then set up during cocktail hour.

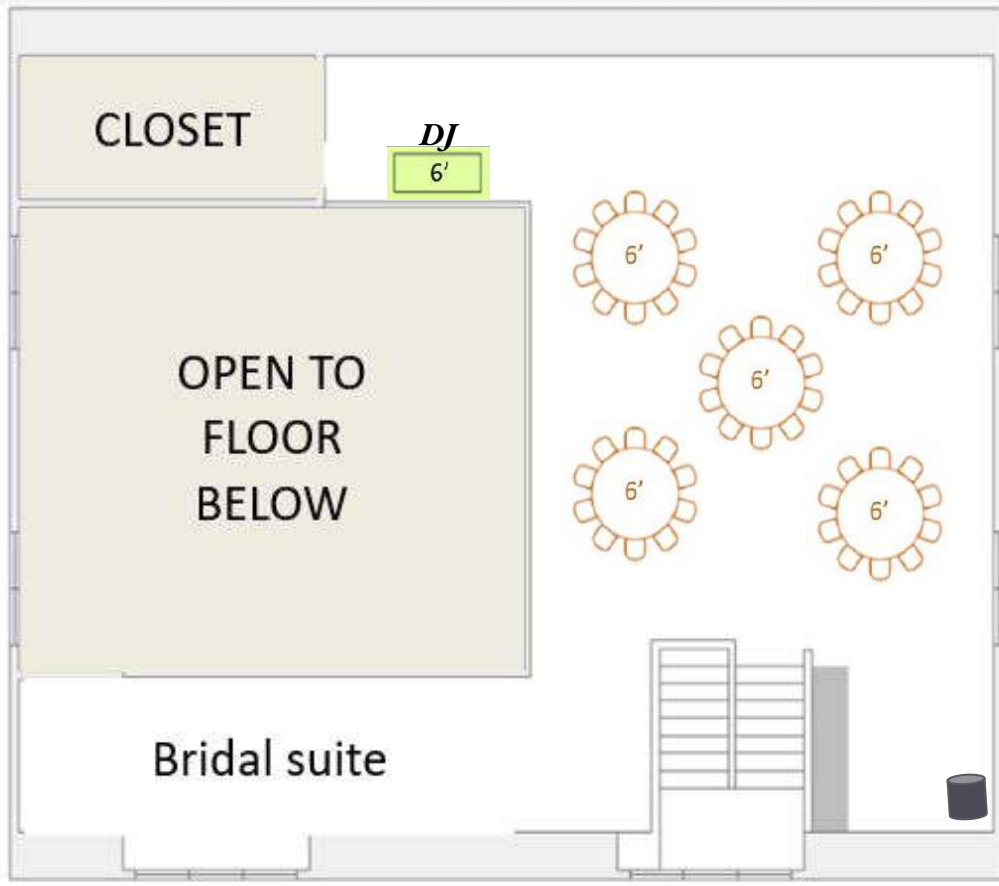



PATIO & COURTYARD

OPTION 4

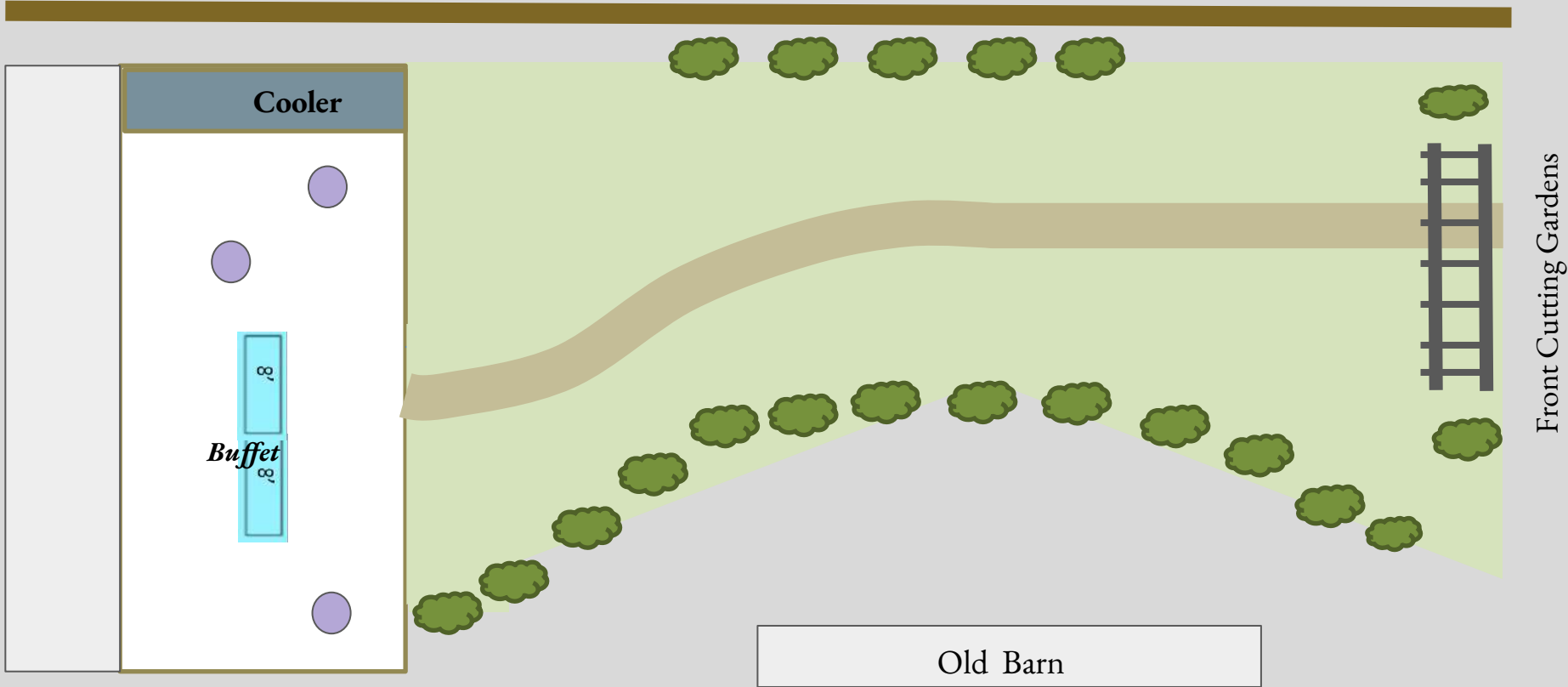



MAIN FLOOR

Spring | Summer | Fall | Winter Wedding Layout

OPTION 5

Main Floor: 58 guests + 10 (or 18) at head (or community table) = 68 (or 76) total

Appetizer table taken down after cocktail hour for dancing

Upstairs: 50 guests

118 or 126 guests total

Patio for Winter Ceremony: 124 seated + bridal party standing

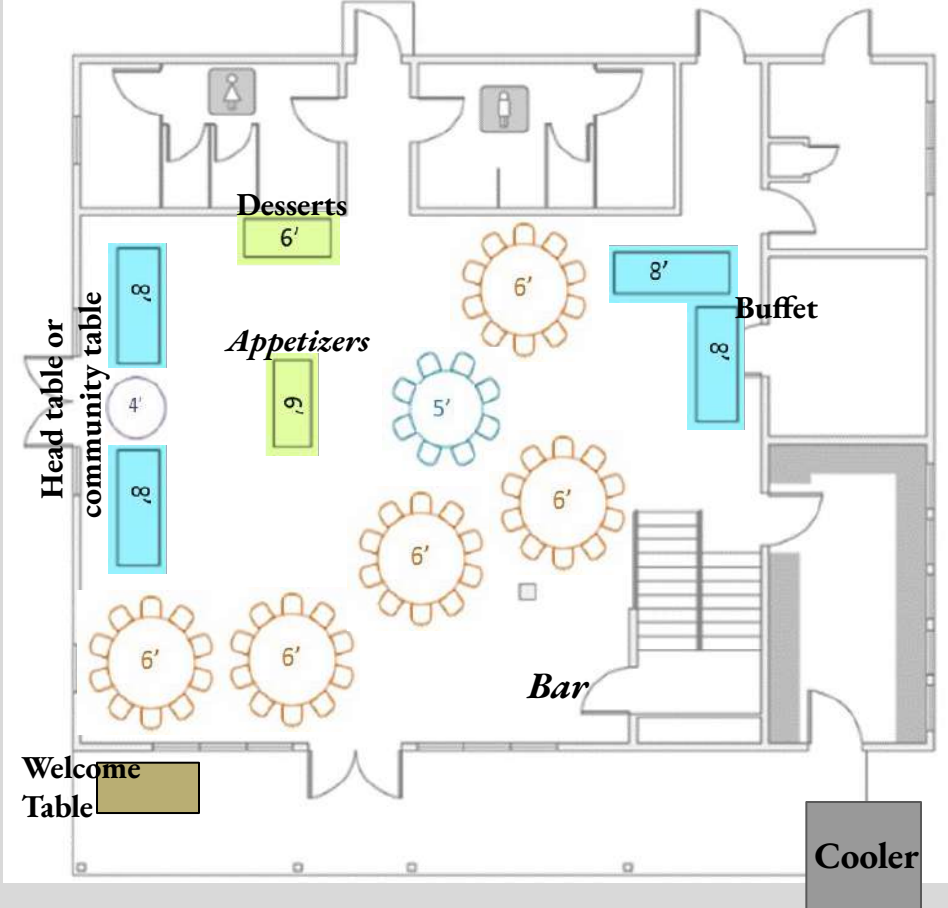

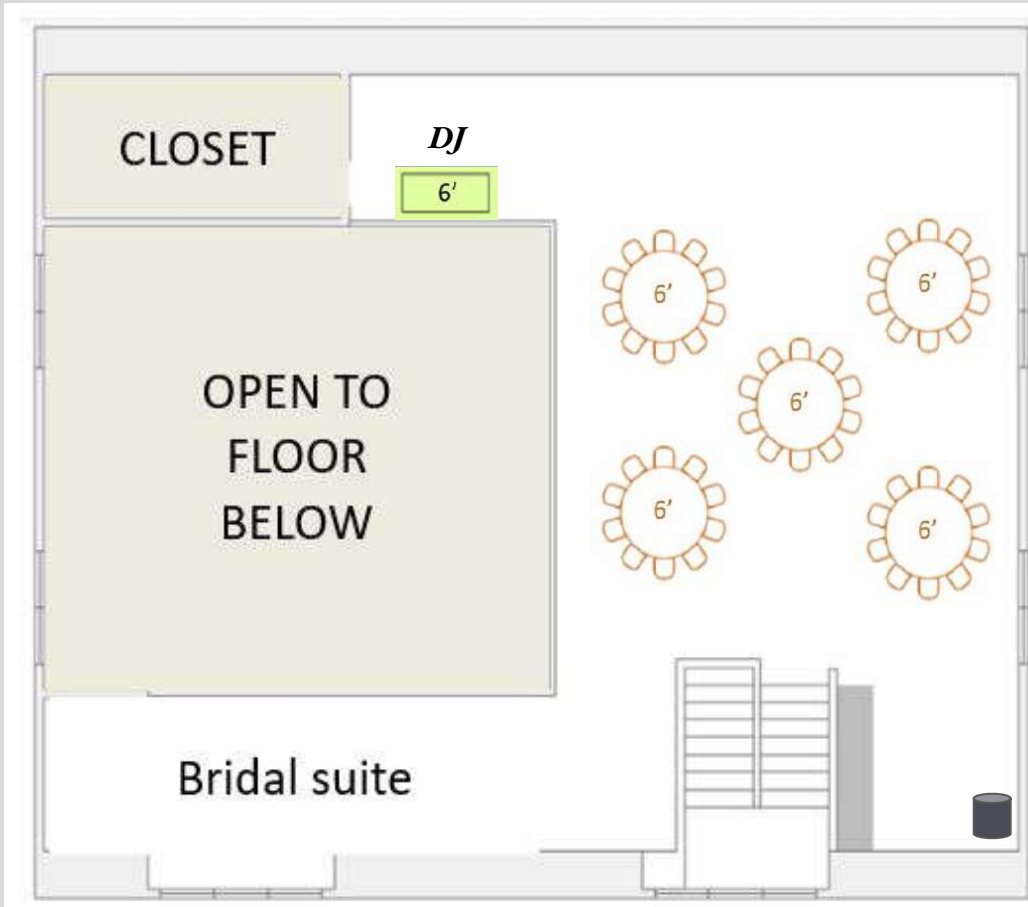

SECOND FLOOR

Spring | Summer | Fall |
Winter Wedding Layout

OPTION 5



PATIO & COURTYARD

OPTION 5

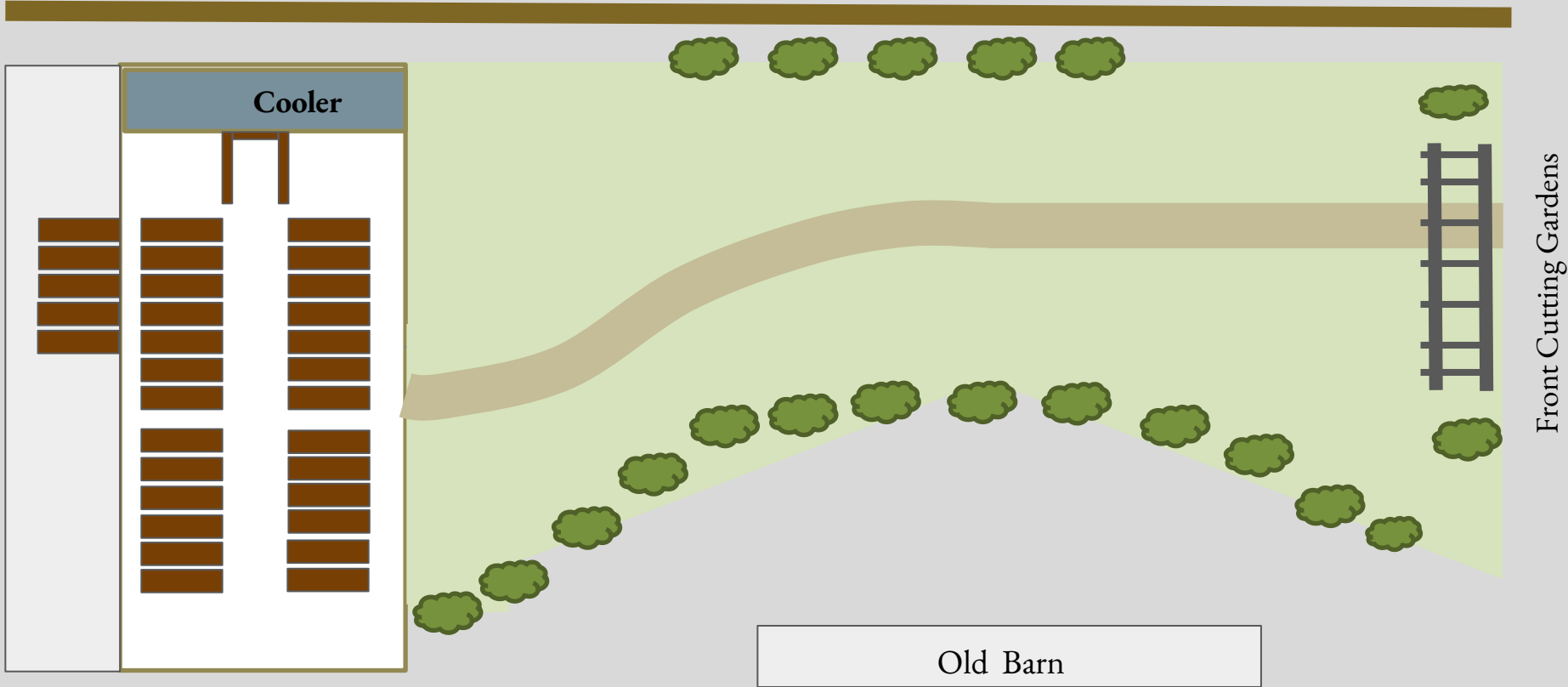



MAIN FLOOR

Spring | Summer | Fall | Winter
Wedding Layout

OPTION 6

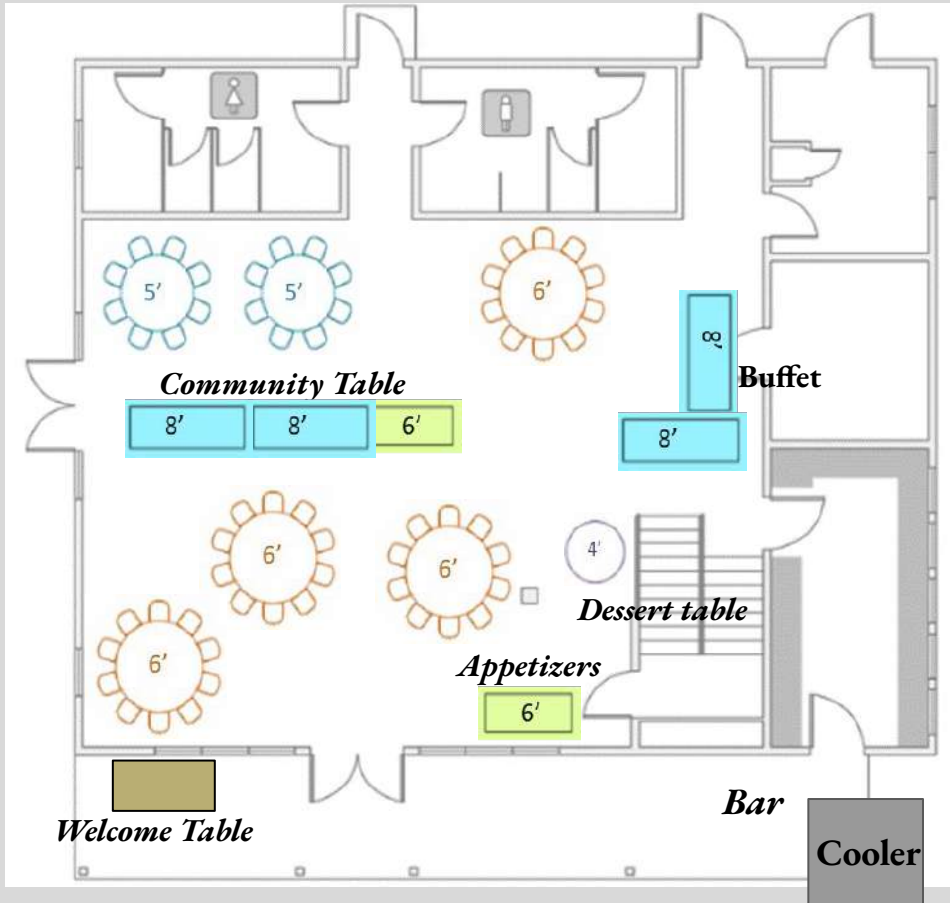

Main Floor: 64 guests + 22 at community table = **86 total**

Community table taken down for dancing after dinner

Patio for Winter Ceremony: 88 seated + bridal party standing



PATIO & COURTYARD

OPTION 6

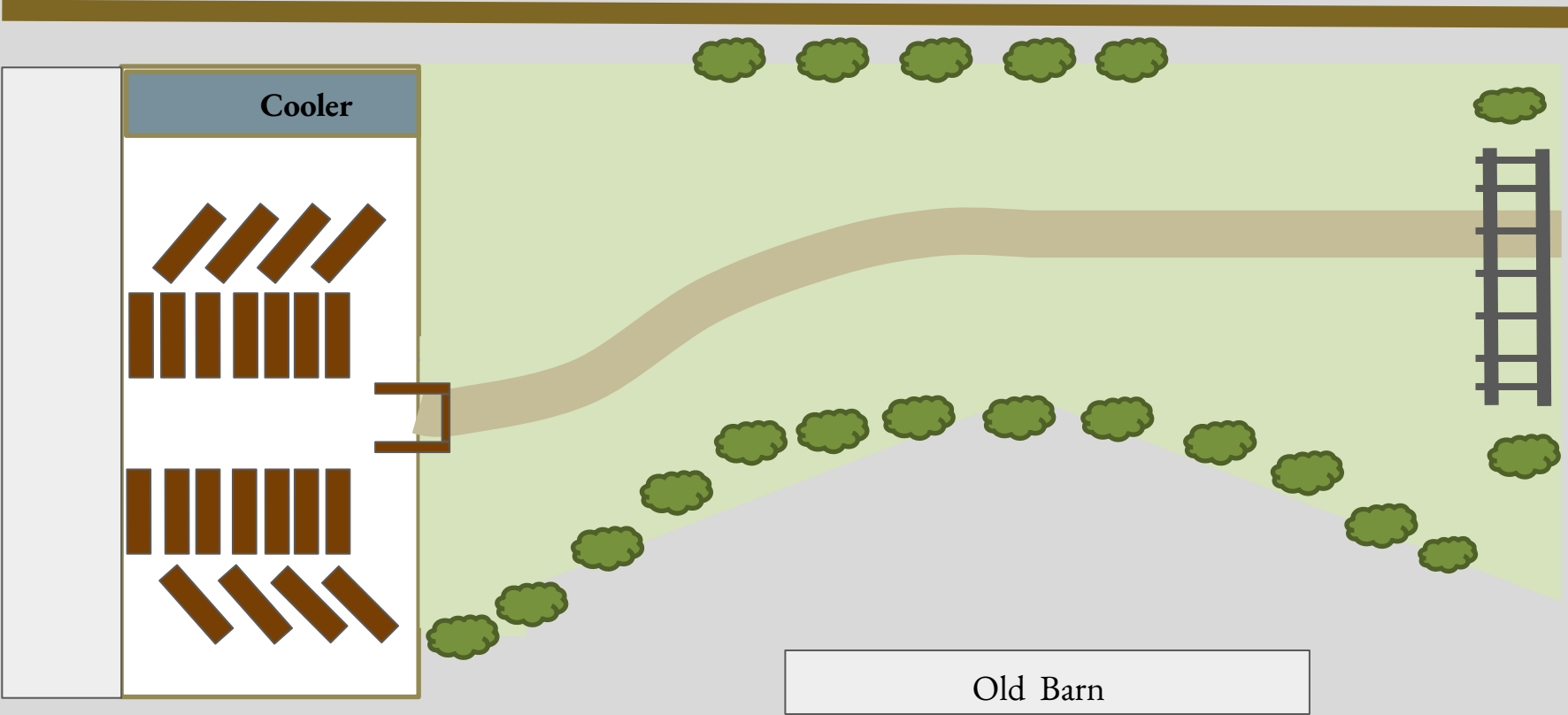

Front Cutting Gardens

Old Barn



MAIN FLOOR

Spring | Summer | Fall | Winter Wedding Layout

PETITE WEDDING OPTION 1

Main Floor: 44 guests + bride and groom

Patio for Winter Ceremony: 40 seated + bridal party standing

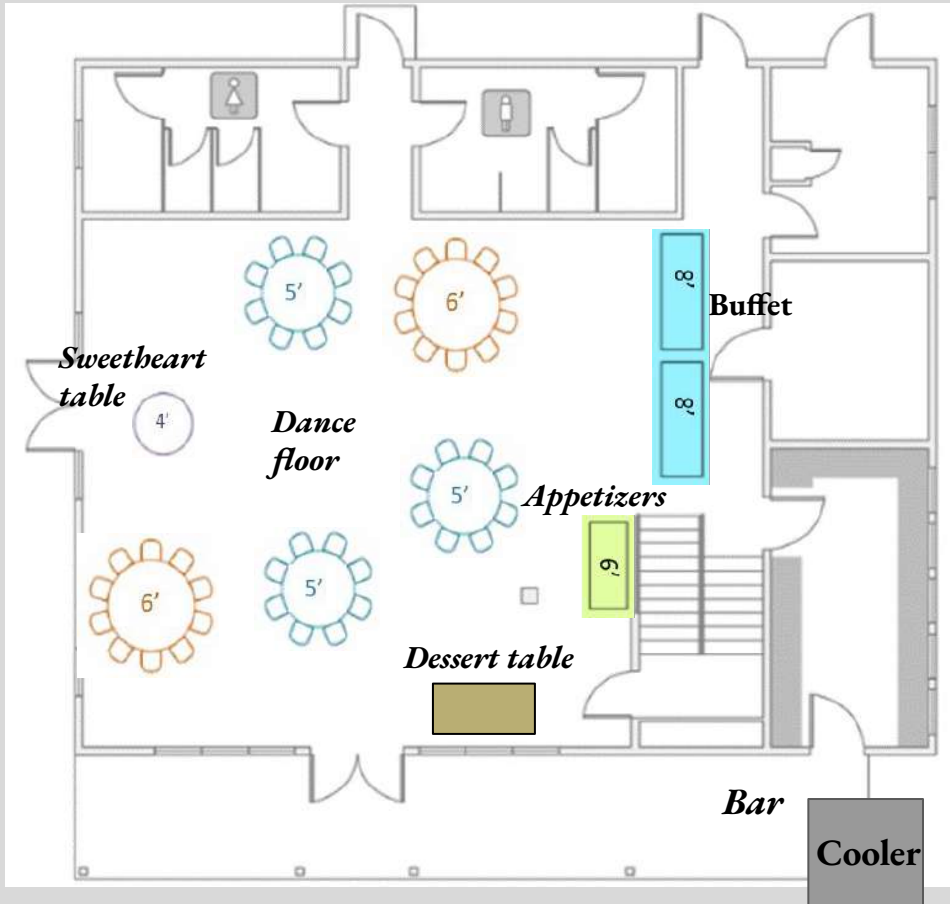



PATIO & COURTYARD

PETITE WEDDING OPTION 1

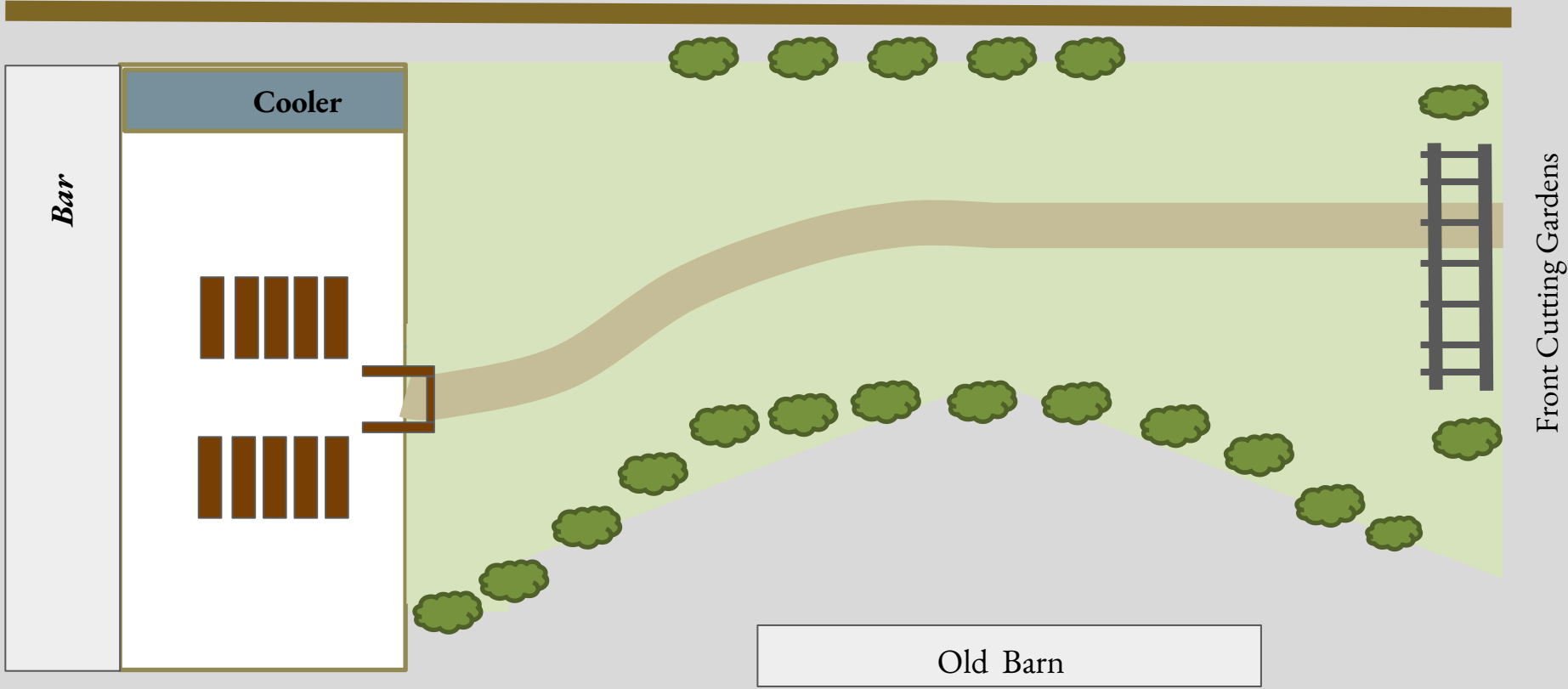



MAIN FLOOR

Spring | Summer | Fall | Winter Wedding Layout

PETITE WEDDING OPTION 2

Main Floor: 32 guests at community table

Dinner with this layout would be plated for a more intimate and upscale feel.

Patio for Winter Ceremony: 40 seated + bridal party standing

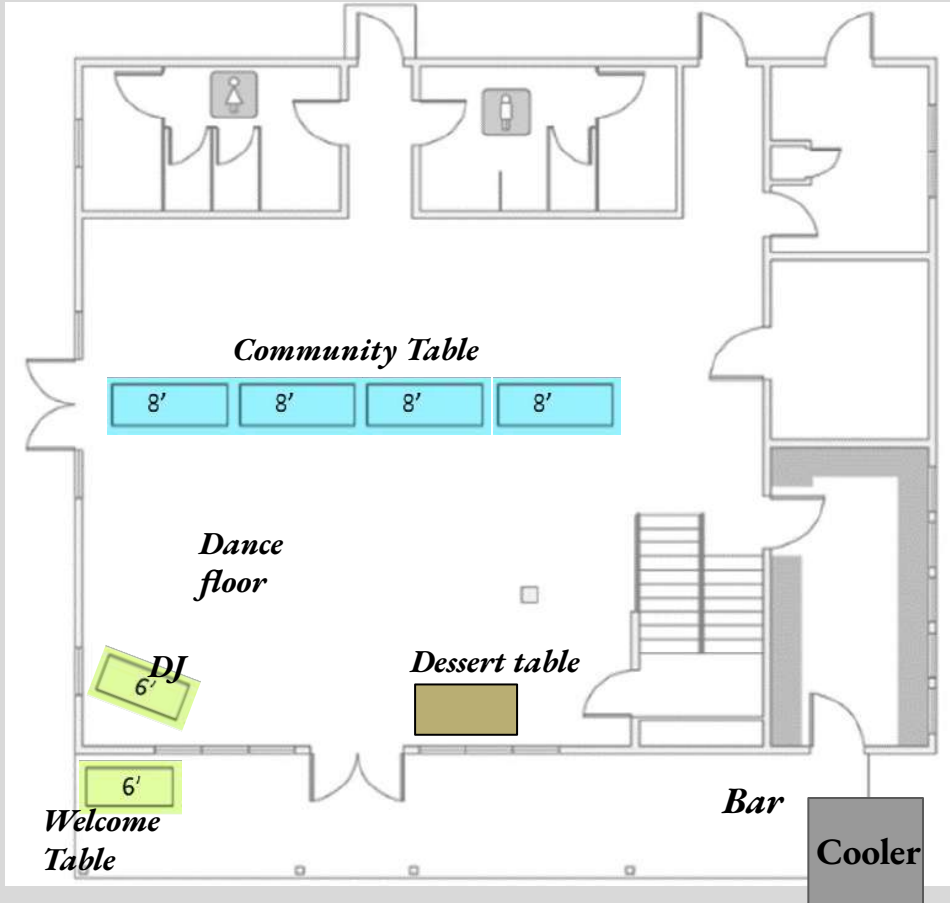



SECOND FLOOR

Spring | Summer | Fall | Winter Wedding Layout

PETITE WEDDING OPTION 2

The upstairs area is a fabulous space for a swanky cocktail hour space. We love seeing it set up with rented furniture and other unique pieces from *Dablia Vintage* to host your guests while they eat lite bites and sip signature cocktails..

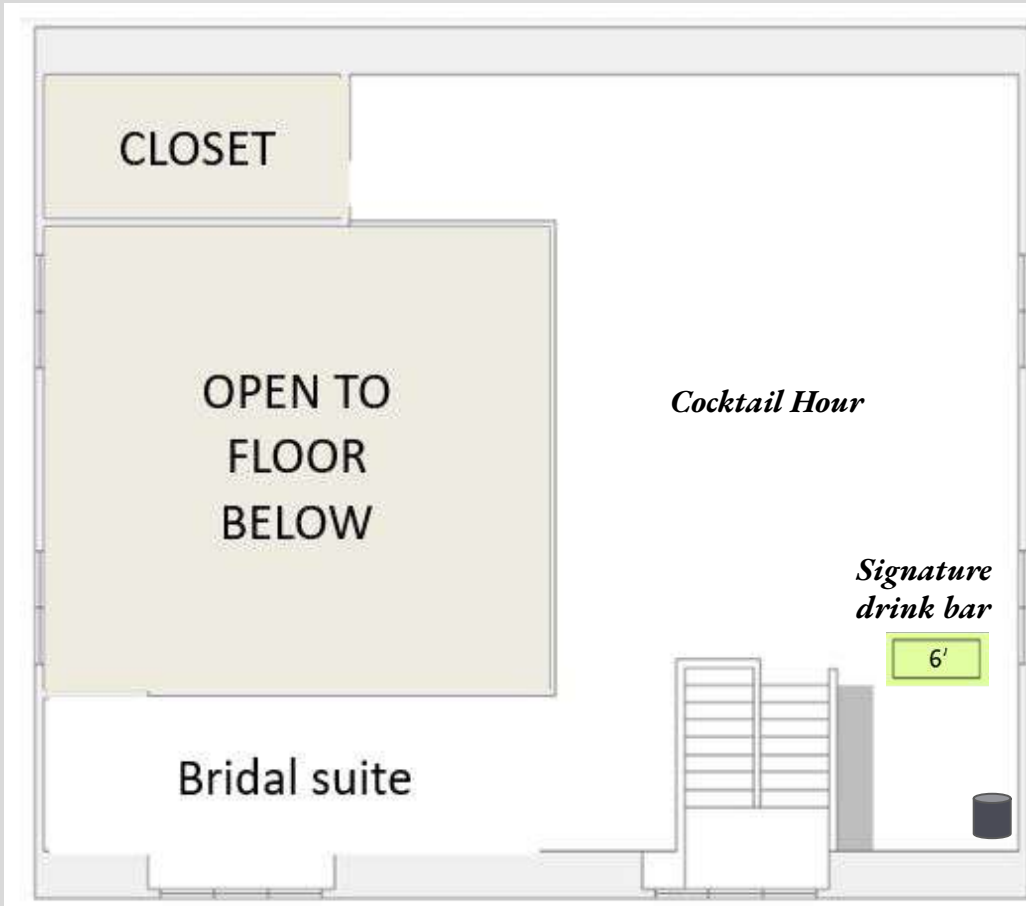



PATIO & COURTYARD

PETITE WEDDING OPTION 2

